

OPI 600 Well Service Pump



Specifications

Maximum Input	600 BHP (447 kW)
Maximum RPM	450
No. of Plungers	3
Stroke Length	6" (152 mm)
Plunger Load	100,000 lbs. (45,400 kg)
Pump Weight	5,000 lbs. (2,270 kg) average
Gear Ratio	4.68:1

OPI 600 Intermittent Duty Well Service Ratings

Plunger Diameter		Displacement per Revolution		Displacement at Pump RPM - Well Service Application															
				100				200				300				450			
in.	mm.	Gal/Rev.	Liter/Rev.	GPM	LPM	PSI	kg/sq. cm	GPM	LPM	PSI	kg/sq. cm	GPM	LPM	PSI	kg/sq. cm	GPM	LPM	PSI	kg/sq. cm
Steel and Stainless Steel Inline Fluid Ends (designed for fluids only)																			
2	51	0.245	0.926	24	93	25000	1758	49	185	18914	1330	73	278	12609	887	110	417	8406	591
2.25	57	0.310	1.172	31	117	25000	1758	62	234	14944	1051	93	352	9963	700	139	527	6642	467
2.5	64	0.382	1.447	38	145	20382	1433	76	289	12105	851	115	434	8070	567	172	651	5380	378
2.75	70	0.463	1.751	46	175	16845	1184	93	350	10004	703	139	525	6669	469	208	788	4446	313
3	76	0.551	2.084	55	208	14154	995	110	417	8406	591	165	625	5604	394	248	938	3736	263
Forged Steel AWS Valve Over Valve Fluid Ends																			
2.75	70	0.463	1.751	46	175	16845	1184	93	350	10004	703	139	525	6669	469	208	788	4446	313
3	76	0.551	2.084	55	208	14154	995	110	417	8406	591	165	625	5604	394	248	938	3736	263
3.5	89	0.749	2.836	75	284	10399	731	150	567	6176	434	225	851	4117	289	337	1276	2745	193
4	102	0.979	3.705	98	370	7962	560	196	741	4729	332	294	1111	3152	222	440	1667	2102	148
4.5	114	1.239	4.689	124	469	6291	442	248	938	3736	263	372	1407	2491	175	557	2110	1660	117
5	127	1.529	5.789	153	579	5096	358	306	1158	3026	213	459	1737	2071	142	688	2605	1345	95
Input Power:		BHP		500				600				600				600			
		kW		373				447				447				447			

Notes: Ratings are based on 90% mechanical efficiency and 100% volumetric efficiency.
Shaded applications to be approved by Gardner Denver Engineering.

OPI 600 Well Service Pump



Standard Features

- Left or right gearbox mounting
- Crankshaft type construction
- Left or right side suction and discharge connections
- Hard coated plungers
- Forged steel fluid end
- Plunger sizes from 2 to 5 inches
- Replaceable WECO discharge connections
- Six inch suction manifold with victaulic connections
- Self adjusting packing standard, non-adjustable packing optional, non-lubricated packing available
- Clamp connections between plungers and pony rods
- Center gauge connection
- Fluid end tool kit

Material Specifications

- | | |
|-------------------------|----------------------------|
| • Cylinder VOV | Forged alloy steel or |
| • Cylinder Inline | Custom 450 stainless steel |
| • Stuffing Box | Steel |
| • Crankshaft | Forged steel |
| • Connecting Rods | High-strength nodular iron |
| • Crossheads | High-strength nodular iron |
| • Main Bearing | Roller |
| • Crankpin Bearing | Bronze |
| • Crosshead Pin Bearing | Bronze |
| • Crosshead Guides | Steel |

Optional Equipment

- Dual discharge flanges
- Additional center gauge connection
- Six inch suction manifold with ANSI flange and/or suction valve lifter cylinder drains
- Tach drive adapter
- Valve seat puller assembly
- Hydraulic torque wrench
- Companion flanges
- Autofrettaged fluid ends (2.75 and 5")
- Plunger material

Fluid End Options

1. Valve over valve
2. Steel in-line
3. Stainless steel in-line

Fluid End	A	B	C	D
1	33.0	53.38	32.3	73.9
2	37.38	53.38	32.3	75.02
3	37.38	53.38	32.3	75.02

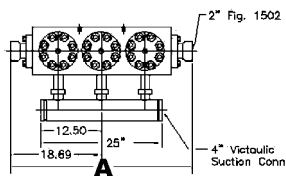

View A

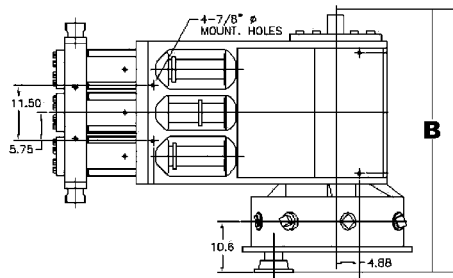

(Inline Fluid End Shown)

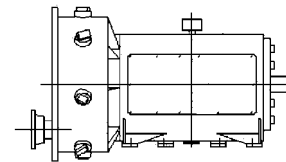
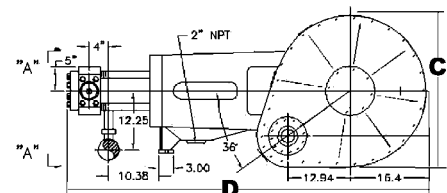

Gardner Denver

Drilling & Production Pumps
Gardner Denver Pump Division
1800 Gardner Expressway
Quincy, IL 62301
Phone: 217-224-8800
Fax: 217-224-7814

Drilling & Production After-Market
Gardner Denver Pump Division
2200 South Prospect
Oklahoma City, OK 73129
Phone: 405-677-5736
Fax: 405-677-5807

Well Service Pumps
Gardner Denver Pump Division
4747 South 83rd East Avenue
Tulsa, OK 74145
Phone: 918-828-7800
Fax: 918-447-6487

After-Market & Repair Facility
Gardner Denver Pump Division
7533 Kathy Lane
Fort Worth, TX 76126
Phone: 817-249-6400
Fax: 817-249-6383

< www.gardnerdenver.com >